

354 EISENHOWER PARKWAY

SUITE#: 2600

LIVINGSTON, NEW JERSEY
4,064 RENTABLE SQ.FT.

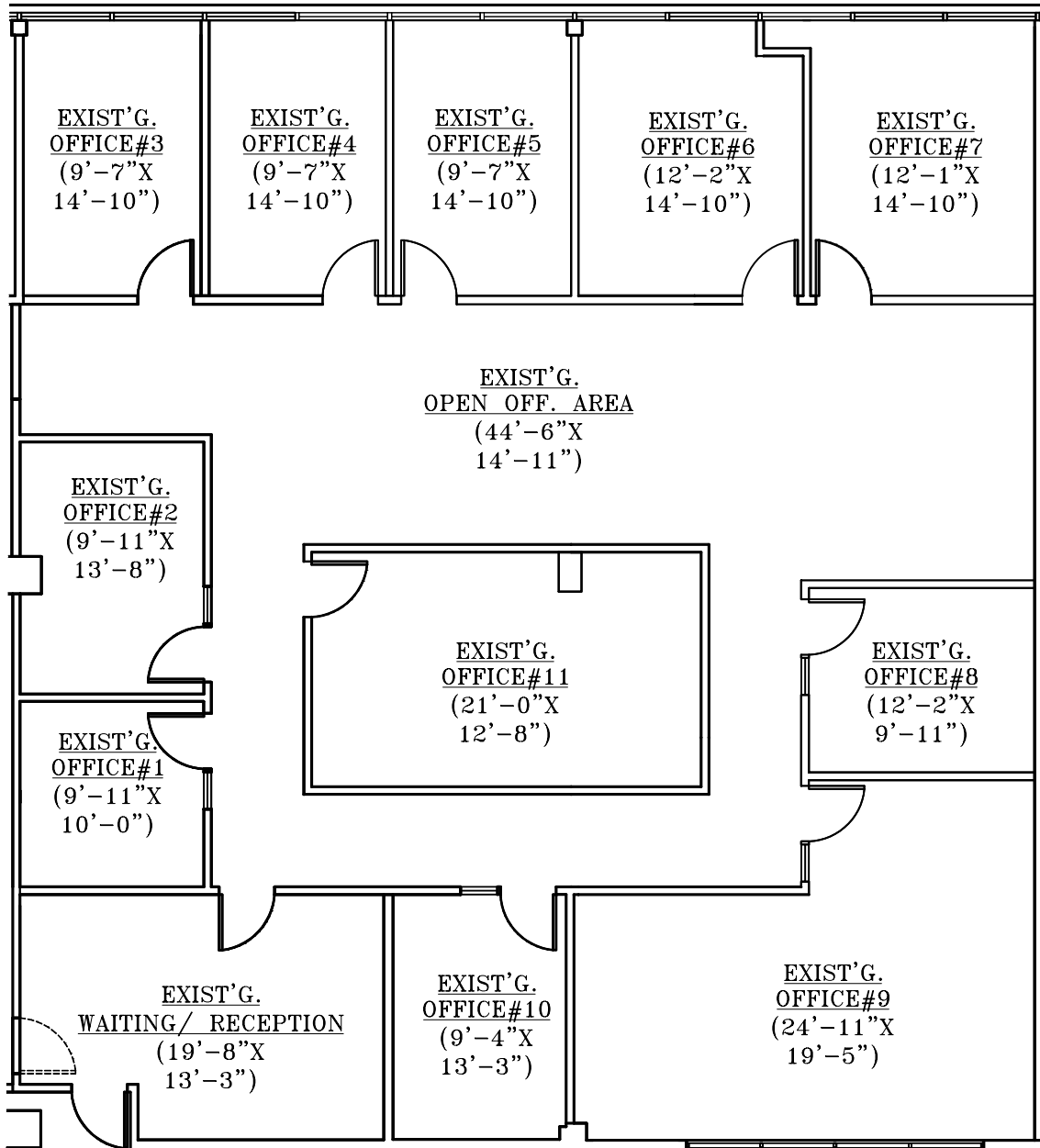

1 PROPOSED FLOOR PLAN
SCALE: NTS

SECOND FLOOR KEY PLAN

■ DENOTES TENANT SPACE

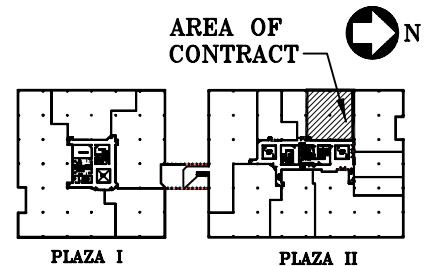

FILE: N:\commercial\354 Eisenhower\MARKETING PLANS\SUITE#2600\2600-EX-1.dwg LAST SAVED DATE: May 22, 2008 - 16:47
CURRENT DATE: May 22, 2008 - 16:54



651 WEST MT. PLEASANT AVE.
LIVINGSTON, NJ 07039
TEL: (973) 992-7727
FAX: (973) 992-3084

EASTMAN
Management Corporation

www.eastmancompanies.com

DATE: MAY. 22, 2008
NOTES: 1.) ALL ROOM SIZES
ARE APPROXIMATE.



WEISS DESIGN GROUP
ARCHITECTURE INTERIOR DESIGN

629 WEST MOUNT PLEASANT AVENUE . LIVINGSTON, NEW JERSEY 07039
973.994.9490 Facsimile 973.994.9889
RONALD WEISS, AIA, NCARB NJ Lic. #10001 NY Lic. #021367